

Z26/...

DIN 7979

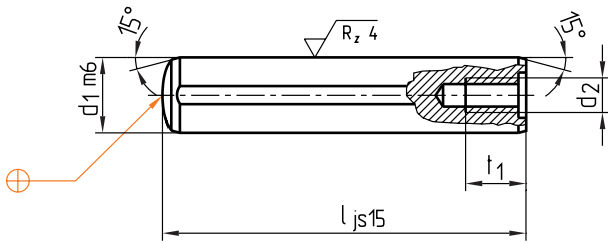

d ₂	t ₁	d ₁	l	Nr./No.
M4	6	6	20	Z26/ 6x20
			24	24
			28	28
			32	32
			40	40
			50	50
M5	8	8	24	Z26/ 8x24
			28	28
			32	32
			40	40
			50	50
			60	60
M6	10	10	32	Z26/10x32
			40	40
			50	50
			60	60
			80	80

d ₂	t ₁	d ₁	l	Nr./No.
M 6	10	12	40	Z26/12x 40
			50	50
			60	60
			80	80
			80	80
M 8	12	14	50	Z26/14x 50
			60	60
			80	80
M 8	12	16	50	Z26/16x 50
			60	60
			80	80
			100	100
			100	100
M10	16	20	60	Z26/20x 60
			80	80
			100	100
			120	120

Z28/...

Mat.: 8.8/800 N/mm²
DIN 934

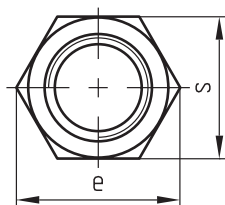
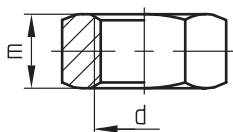

m	s	e	d	Nr./No.
2,2	5,5	6	M3	Z28/3
2,9	7	7,7	M4	4
3,7	8	8,8	M5	5
4,7	10	11,1	M6	6
6,1	13	14,4	M8	8

m	s	e	d	Nr./No.
7,6	17	18,9	M10	Z28/10
9,6	19	21,1	M12	12
10,3	22	24,5	M14	14
12,3	24	26,8	M16	16
14,9	30	33	M20	20

This is trial version
www.adultpdf.com